

Save: 3/23/2023 10:47 AM c:\pds\Plot: 3/23/2023 12:55 PM X:\F\H\HOLLT1705005-final-dsgn\51-drawings\10-Civil\cad\dwg\sheet\HO170500DT.dwg

DRAWN BY:	CMC			
DESIGNER:	JJT			
CHECKED BY:	JJT			
DESIGN TEAM		NO.	BY	DATE
				REVISIONS



PHONE: 608.782.3161
329 JAY STREET, SUITE 301
LA CROSSE, WI 54601-4034
www.sehinc.com

**TOWN OF HOLLAND,
WISCONSIN**

CONSTRUCTION DETAILS

FILE NO.
HO170500

2
4

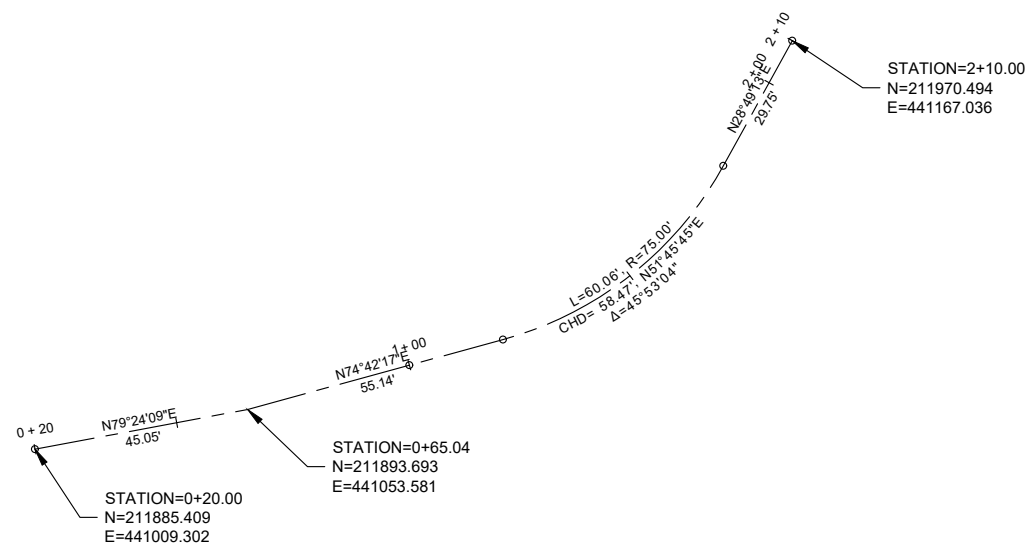

ALIGNMENT DATA

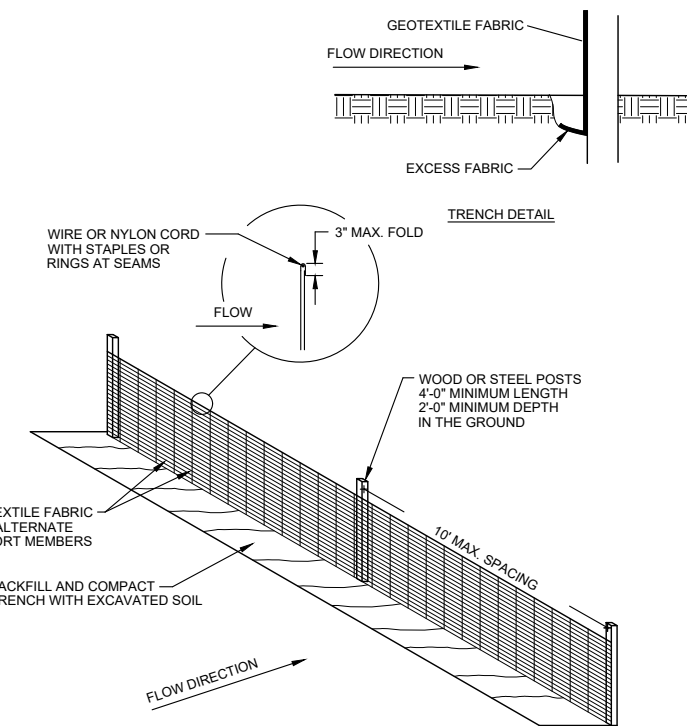

SILT FENCE

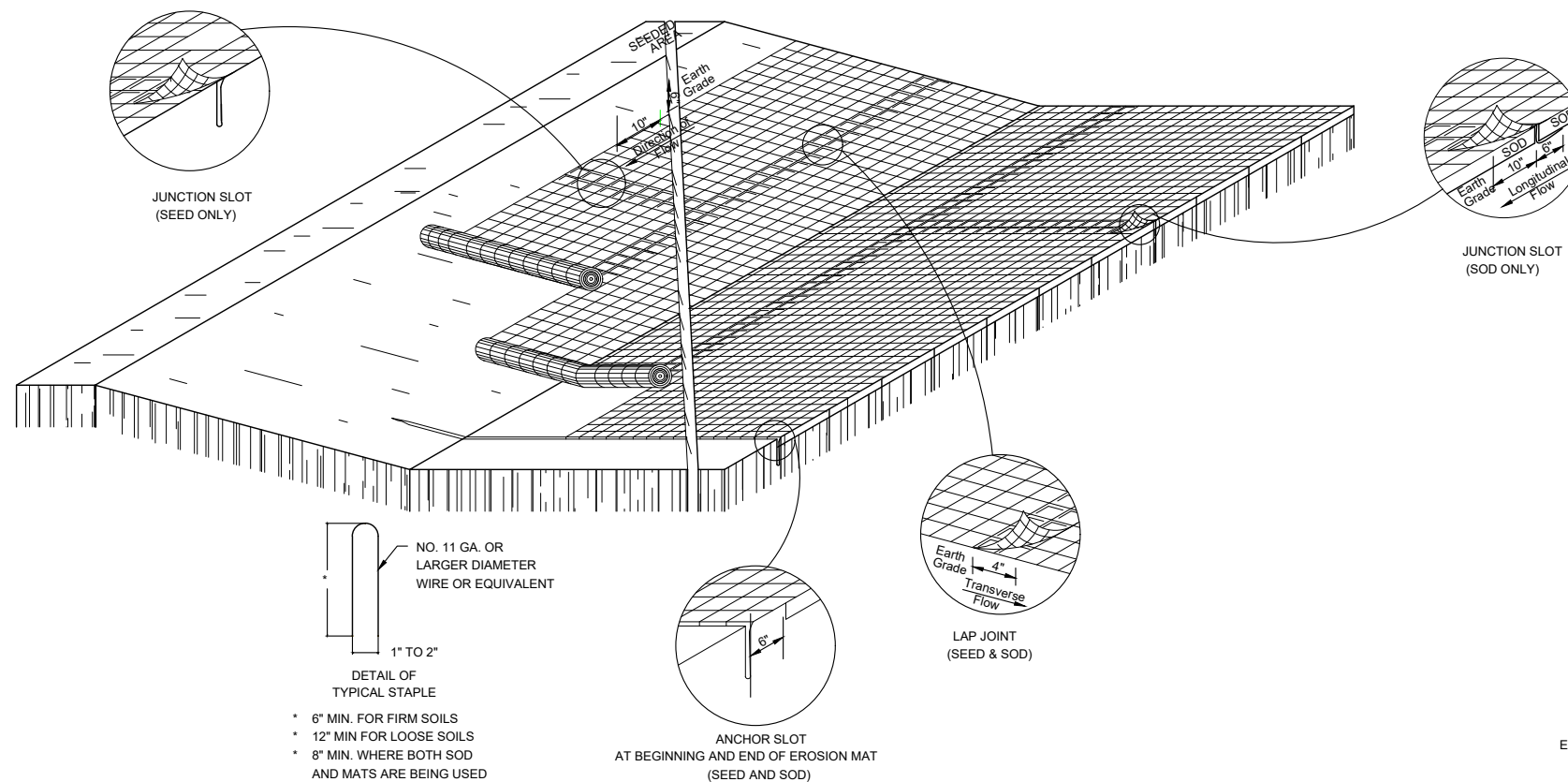

EROSION MAT AND SOD

EROSION CONTROL

GENERAL NOTES: DETAILS OF CONSTRUCTION, MATERIALS AND WORKMANSHIP NOT SHOWN ON THIS DRAWING SHALL CONFORM TO THE PERTINENT REQUIREMENTS OF THE STANDARD SPECIFICATIONS AND THE APPLICABLE SPECIAL SPECIFICATIONS.

VARIATIONS IN THE DIMENSIONS OF MATERIALS SHOWN HEREON SHALL BE PERMITTED IF THEY PROVIDE EQUIVALENT PROTECTION AND MATERIAL STRENGTH AND IF PRIOR APPROVAL OF THE ENGINEER IS OBTAINED.

LAP JOINTS SHALL NOT BE PLACED IN THE BOTTOM OF V-SHAPED DITCHED.

JUNCTION SLOTS ON ADJACENT STRIPS OF MATTING SHALL BE STAGGERED A MINIMUM OF 4 FEET APART.

EDGES OF THE EROSION MAT SHALL BE IMPRESSED IN THE SOIL.

EROSION MAT OVER SOD:

A: ONLY JUTE FABRIC WILL BE PERMITTED OVER SOD.

B: ROAD STAKES FOR THE SOD MAY BE OMITTED BY THE ENGINEER IF THE EXISTING SLOPE AND SOIL CONDITIONS SO WARRANT.

C: THE WIDTH OF EROSION MAT SHALL ALWAYS EQUAL THE SOD WIDTH.

D: SOD STRIPS MAY BE PLACED EITHER LONGITUDINALLY OR TRANSVERSELY TO THE FLOW LINE OF THE DITCH.

EROSION MAT OVER SEEDING: JUNCTION OR ANCHOR SLOTS SHALL BE AT MINIMUM INTERVALS OF 100 FEET ON GRADES UP TO AND INCLUDING 3 PERCENT, AND 50 FEET ON GRADES EXCEEDING 3 PERCENT.

Save: 3/23/2023 10:47 AM cers Plot: 3/23/2023 12:55 PM X:\F\JH\HOLLT1705005-final-dsgn\51-drawings\10-Civil\cad\dwg\sheet\H0170500DT.dwg

DRAWN BY: CMC				
DESIGNER: JJT				
CHECKED BY: JJT				
DESIGN TEAM	NO.	BY	DATE	REVISIONS

PHONE: 608.782.3161
329 JAY STREET, SUITE 301
LA CROSSE, WI 54601-4034
www.sehinc.com

TOWN OF HOLLAND,
WISCONSIN

CONSTRUCTION DETAILS

FILE NO. HO170500
3
4

NOTES:
 CONTRACTOR TO STAGE OPERATIONS AND UTILIZE FLAGGING OPERATIONS TO MAINTAIN AT LEAST ONE 12-FT LANE OF TRAFFIC AT ALL TIMES DURING WORKING HOURS. TWO 12-FT WIDE LANES OF TRAFFIC MUST BE MAINTAINED DURING NON-WORKING HOURS. NO DROPOFFS GREATER THAN 4-INCHES SHALL BE ALLOWED DURING NON-WORKING HOURS UNLESS PROTECTED PER WISDOT STANDARDS.

PROVIDE AND MAINTAIN BARRICADES, SIGNAGE, DRUMS, AND ALL OTHER TEMPORARY TRAFFIC CONTROL DEVICES IN ACCORDANCE WITH APPLICATION MUTCD AND WISDOT STANDARD DETAILS REQUIREMENTS OR AS DIRECTED BY THE ENGINEER.

SALVAGE AND REINSTALL NARROW ROAD SIGNS AND POSTS. THIS WORK IS CONSIDERED INCIDENTAL.

FIELD ADJUST GRADING TO AVOID NEED FOR TREE CLEARING.

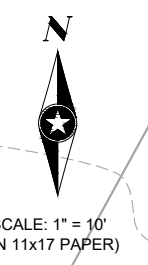

REMOVE EXISTING 36" CMP CULVERT AND 4'X5' STONE MASONRY BOX CULVERT
 APPROXIMATE LENGTH OF CMP PIPE=25 LF
 APPROXIMATE LENGTH OF BOX CULVERT=20'
 (LENGTH AND SIZES PROVIDED FOR INFORMATION ONLY. CONTRACTOR TO VERIFY)

FILL AT 3:1 SLOPE
 MATCH TO SURROUNDING GRADE

BEGIN PROJECT
 STATION=1+00.00
 SAWCUT REQ'D

REMOVE GUARDRAIL

MATCH TO SURROUNDING GRADE

END PROJECT
 STATION=1+50.00
 SAWCUT REQ'D

SILT FENCE REQ'D

MEDIUM RIPRAP WITH
 GEOTEXTILE FABRIC TYPE R

EROSION BALES REQ'D

1+33.35, -20.64 L
 INV=851.05

STATION=1+50.00
 OFFSET=13.70 L

STATION=1+43.14
 OFFSET=21.30 R

1+21.22, 25.77 L
 INV=848.61

Save: 3/23/2023 10:46 AM cers Plot: 3/23/2023 12:56 PM X:\F:\H\HOLLT\1705005-final-dsgn\51-drawings\10-Civil\cad\dwg\sheet\HO1705005.dwg

DRAWN BY:				
DESIGNER:				
CHECKED BY:				
DESIGN TEAM	NO.	BY	DATE	REVISIONS



TOWN OF HOLLAND,
 WISCONSIN

PLAN

FILE NO.
 HO170500

4
 4